

Ready Stand

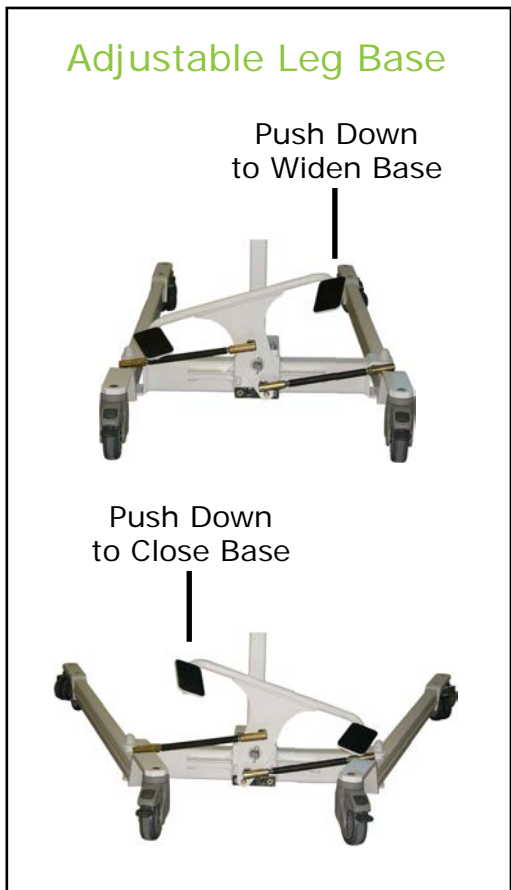

HUMAN CARE
Your Life. Your Way.

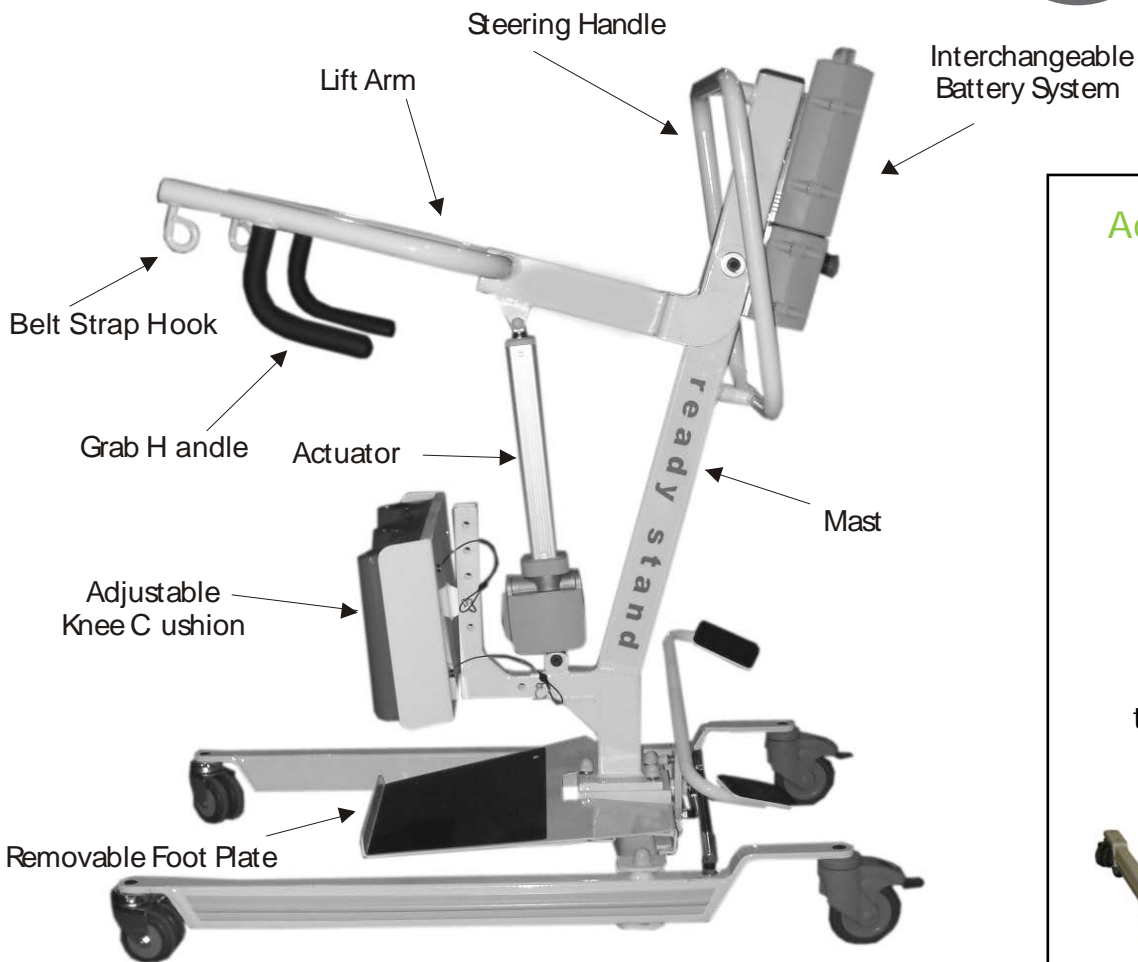

Belt Placement

Select and position the appropriate belt around the patient as per belt application instructions.

Belt Buckle

Buckle assembly open

Buckle assembly closed

Locking Casters

Before lifting the patient, lock the rear casters. To lock them, step down on the gray locking tab (1). To release the lock, step on the lock release tab (2) *highlighted in red*.



Battery and Electronics Pack Overview

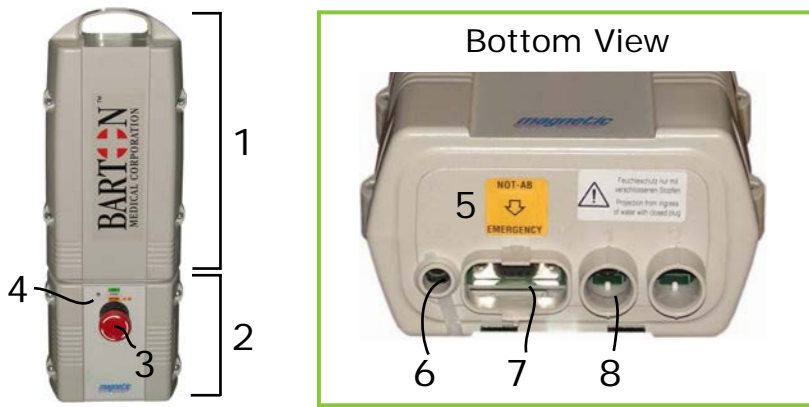

- 1. Battery Pack
- 2. Electronics Pack
- 3. Emergency Stop
- 4. Charge Indicator LED
- 5. Emergency Lowering
- 6. Charging Port
- 7. Hand Control Port
- 8. Lift Motor Port

Hand Control Overview

Use the hand control to raise or lower the lift are by pressing the UP or DOWN buttons as indicated below.

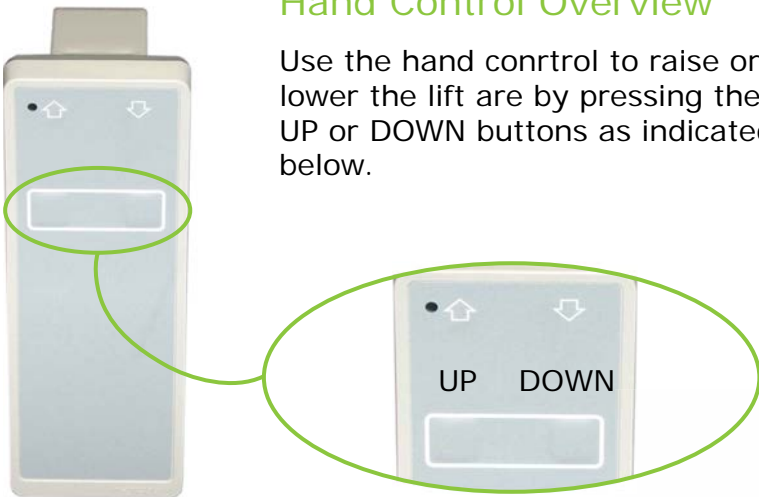

Electronics Pack Features

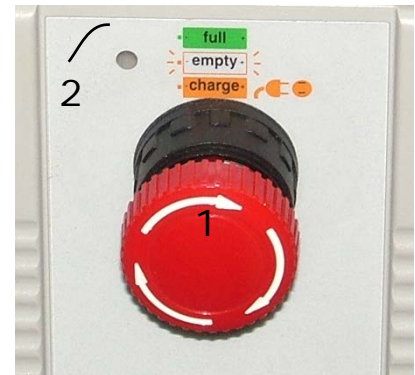

- 1. RED Emergency Stop Button
 - Press button to shut off.
 - Turn the button to disengage.

- 2. Charge Indicator LED:

Green light - battery charged.
 Amber light - battery is charging.
 Flashing Amber light - battery is low/empty

Removing Battery Pack



TO REMOVE
Lift pack up using handle. Once clear of the plug, pull away from the slots on the electronics pack mounting frame.

TO REPLACE
Position the metal tabs on the back of the battery pack into the slots on the electronics pack mounting frame. Push the battery down so the plug on the electronics pack sits in the battery.

Manual Lowering

To lower the lift arm manually, unlock the red handle on the top of the lift motor (1).

Turn the barrel on the lift motor to lower the lift arm (2).

