

MODEL: XTW6035 L/R

ESCAPE 6035

SHOWN WITH OPTIONAL JET SYSTEMS

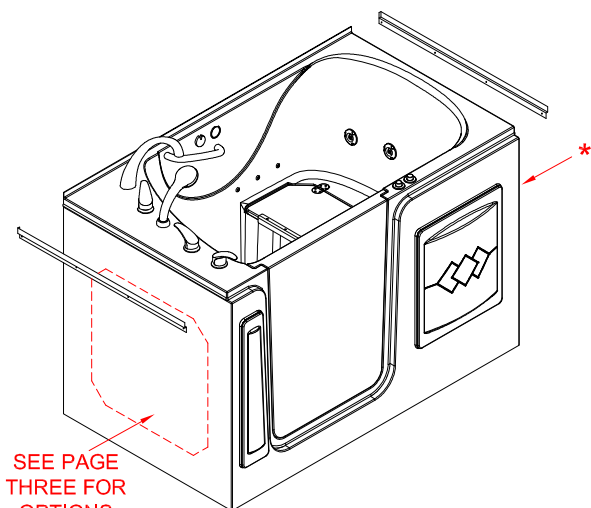

PERSPECTIVE VIEW - N.T.S.
MODEL SHOWN HERE AS:
 LEFT HAND BATHTUB
 HUNTINGTON BRASS $\frac{3}{4}$ " VALVE
 AIR/WATER COMBO JET SYSTEMS

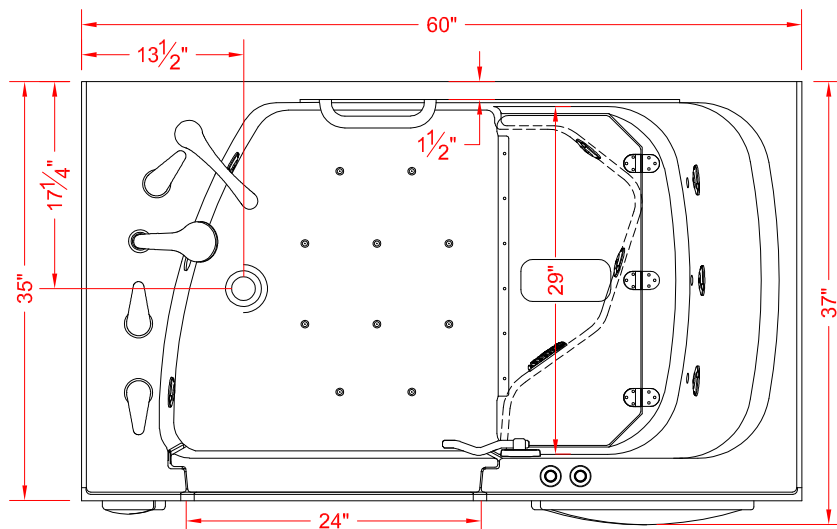

TOP VIEW - SCALE $\frac{3}{4}$ " = 1'-0"

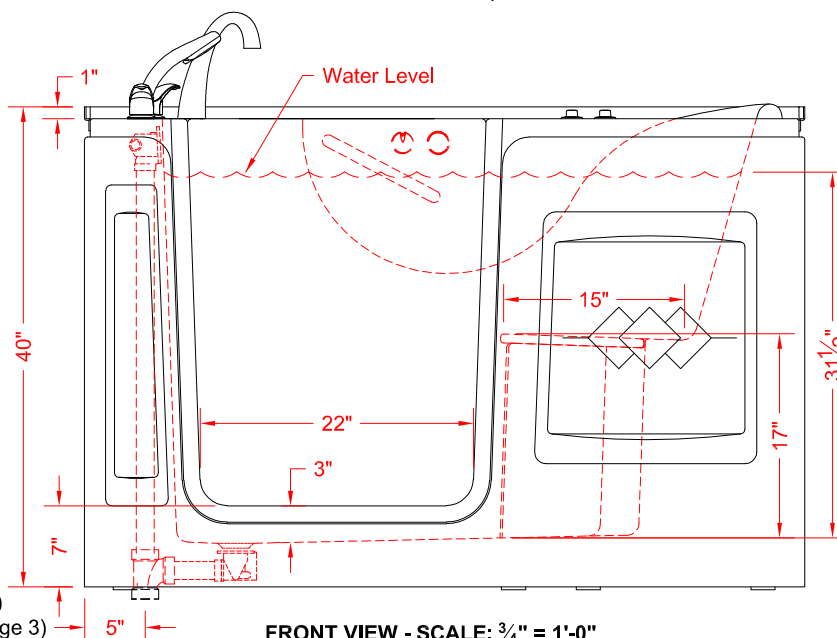

FRONT VIEW - SCALE: $\frac{3}{4}$ " = 1'-0"

Features:

- Swing up seat for easy entry
- Seat height is designed for ease of sitting and standing
- Extra deep for a full body soak
- Patented door lever-handle designed for easy operation
- Reliable door seal that comes with a limited lifetime warranty
- Allows you the freedom to rehab at home
- Installs in alcove, corner or along a wall
- 2" drain for faster draining
- Optional air/water or microbubble upgrades available (page 2)
- Optional access hole(s), end panel(s), and wall surrounds (page 3)

PRODUCT SPECIFICATIONS:

-Extra-large soaker or jetted walk-in bathtub with pressure sealed door shall be of gelcoat / composite construction, have an integral front skirt and magnetically attached access panels for plumbing.

C.S.I. FORMAT SPECIFICATION TEXT AVAILABLE

PRODUCT INFORMATION:

- Accessories: factory installed tub bar and optional plumbing rough-in, all other accessories installed by others
- Colors: White standard
- Fill volume with a 400 lbs. bather: 130 gallons*

-Soaker tub weight, dry, approx. 260 lbs.
 (ship weight 325 lbs.)
 -Total weight of soaker tub, bather, and water:
 approx. 1,490 lbs.

-Jetted tub weight, dry, approx. 310 lbs.
 (ship weight 375)
 -Total weight of jetted tub, bather, and water:
 approx. 1,540 lbs.

ACCESSORIES:

STANDARD:

- Tub bar
- 2" cable operated drain assemblies
- Side nailing flanges

OPTIONAL:

- Roman tub filler package options
- Thermostatic mixing valve options
- Grab bars for installation on wall surround
- Air/water jet combination or microbubble system upgrade for additional therapy
- Ozone sanitation for hydrotherapy system
- Flange trim kit

* NOTE: $\frac{3}{4}$ " hot and cold supply lines are recommended to reduce fill time.

CODES:

Designed and manufactured in compliance with the following standards and codes:

- CSA B45.5-11 / A.N.S.I. Z124-2011 Plastic Plumbing Fixtures
- A.S.M.E. A112.19.7M-1995 Whirlpool Bathtub Appliances
- A.S.M.E. A112.19.8M-1987 Suction Fittings for use in Whirlpool Bathtubs
- A.S.M.E. A112.19.15-2001 Bathtubs/Whirlpool Bathtubs with pressure sealed doors
- Underwriters Laboratories 1795 Hydro Massage Bathtubs



We reserve the right to make revisions without notice in the design of fixtures or in packaging unless this right has specifically been waived at the time the order is accepted.

OPTIONAL HYDROTHERAPY PACKAGES

Escape 6035 Air and Water Jet System Combination: **6035JETS***

Air and water jet combination upgrade includes: heated air blower with 19 chrome air jets, heat-recycling water jet pump with 7 adjustable chrome jets, and an electric seat heater to warm the seat during filling and draining. Jet systems are controlled with air buttons into one main controller unit requiring only one dedicated 20 amp circuit to power all systems.

Ozone sanitation system* can be added to this package for water recirculation sanitation without additional power requirements.

*P/N: OZONATOR

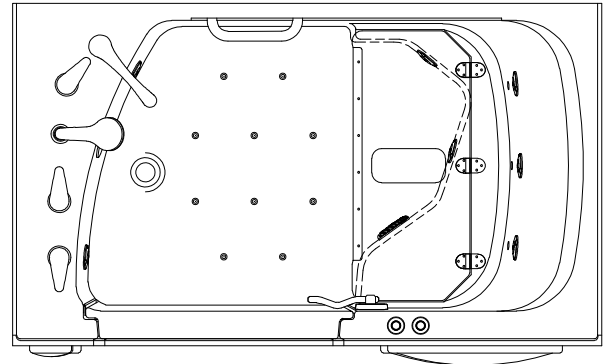

Escape 6035 Microbubble System: **MICROBUBBLES***

Microbubble upgrade includes: microbubble system and an electric seat heater to warm the seat during filling and draining. Microbubble system is controlled with an air button into one main controller unit requiring only one dedicated 20 amp circuit to power the microbubble pump and seat heater.

Ozone sanitation system* can be added to this package for water recirculation sanitation without additional power requirements.

*P/N: OZONATOR

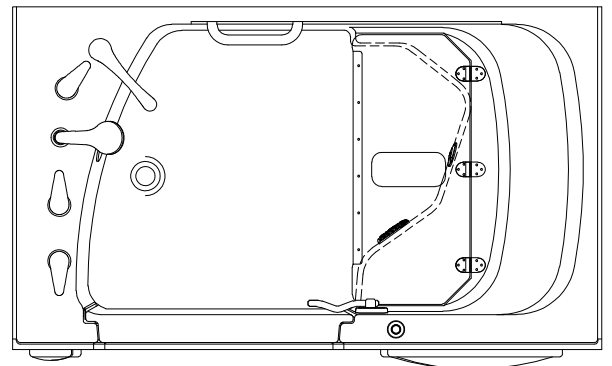

Power requirements for either hydrotherapy upgrade: 120V/20A

Water pump - US/CAN: Syllent MB71E0032AS/UL

Air blower - US/CAN: CG Air SLO-3-75-120/60A-N

Microbubble pump - US/CAN: CG Air PP-01-N

Suction fitting: CG Air SUC-S

ESCAPE 6035 WALK-IN BATHTUB

OPTIONAL INSTALLATION ACCESSORIES:

①

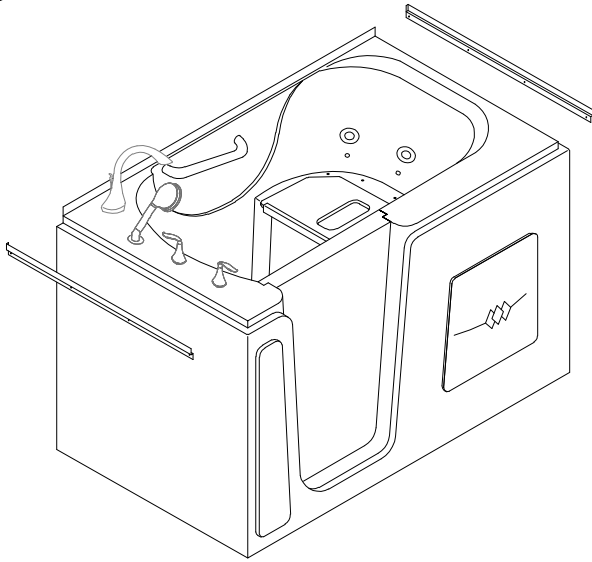

As-is, no additional parts included to install in a 60" ALCOVE or along a STRAIGHT WALL

②

Escape 6035 Access Hole Cut(s) SHOWN HERE

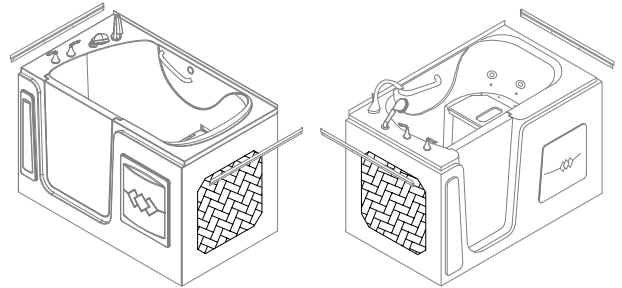

- With Plumbing/Electrical Access Holes
- Can be custom cut from plumbing and/or seat end
- For a CORNER or ALCOVE installation

CU9 (indicate plumbing, seat, or both ends)

③

6035EP** SHOWN HERE

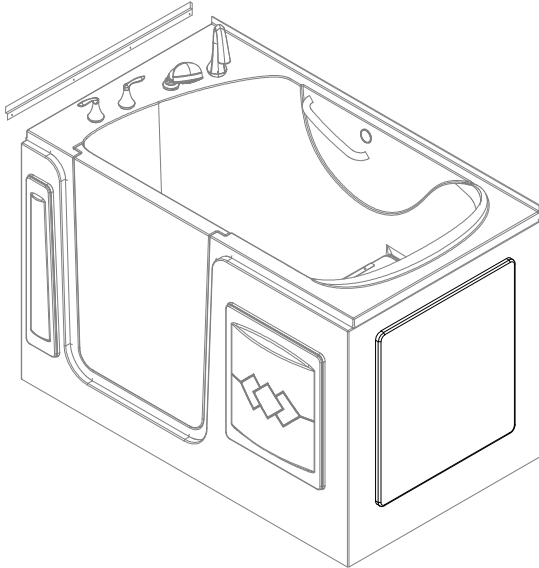

- With End Panel
- For a CORNER or STRAIGHT WALL installation

Escape 6035 End Panel
Model # 6035EP

** END PANEL DESIGNED FOR MOUNTING ON SEAT END
FOR END PANEL ON PLUMBING END, REQUEST A QUOTE

3SWS6035 SHOWN HERE

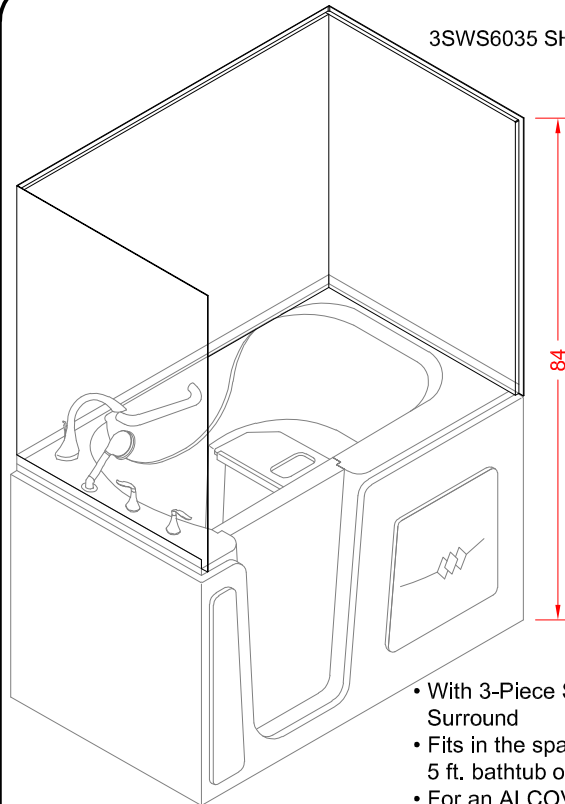

- With 3-Piece Smoothwall Wall Surround
- Fits in the space of a typical 5 ft. bathtub or shower
- For an ALCOVE installation

Escape 6035 Wall Surround
Model # 3SWS6035

MODEL: XTW6035 L/R

OPTIONAL END ACCESS PANEL

ESCAPE 6035

